

Dixon® Cam & Groove Handles

Features:

- stainless steel pins standard with all assemblies
- roll pins are 302 stainless, solid pins are 303 stainless
- pull rings are standard on sizes 1¼" thru 6", optional on other sizes
- Domestic Dixon® standard handle assemblies are only to be used with standard Dixon® parts (not global). Handles do not interchange with other manufacturer's handles or couplers. 

| Coupler Size | Description | Brass Part # | 316 Sintered Stainless Steel Part # |
|--------------|-----------------------|-------------------|-------------------------------------|
| ½" | cam arm and pin | --- | 50-HP-SP |
| ¾" | cam arm and pin | --- | 75-HP-SP |
| 1" | cam arm and pin | --- | 100-HP-SP |
| 1¼" - 2½" | cam arm, ring and pin | 200-HRP-BR | 200-HRP-SP |
| 3" - 5" | cam arm, ring and pin | 300-HRP-BR | 300-HRP-SP |
| 6" | cam arm, ring and pin | 600-HRP-BR | --- |
| 8" | cam arm and pin | 800-HNP-BR | --- |

| Coupler Size | Description | 316 Investment Stainless Steel Part # |
|--------------|-----------------------|---------------------------------------|
| 2" | cam arm, ring and pin | 200-HSCR-SP |
| 3" | cam arm, ring and pin | 300-HSCR-SP |
| 6" | cam arm, ring and pin | 600-HRP-SI |



brass



316 sintered stainless steel



316 investment stainless steel

Cam & Groove

C

Dixon® Cam & Groove Locking Handles for Dust Caps

Features:

- Dixon® locking handles are only to be used with standard Dixon® parts (not global). Handles do not interchange with other manufacturer's handles or couplers. 
- not supplied with pins

| Coupler Size | Hole Diameter | Brass Part # | 316 Investment Stainless Steel Part # |
|--------------|---------------|------------------|---------------------------------------|
| 2" | 9/32" | 200-LH-BR | 200-LH-SI |
| 3" | 5/16" | 300-LH-BR | 300-LH-SI |
| 4" | ¾" | 400-LH-BR | 400-LH-SI |



200-LH-SI



300-LH-BR

Boss-Lock™ Cam & Groove Handles

Feature:

- Boss-Lock™ handles should only be used with Boss-Lock™ parts. Handles do not interchange with other manufacturer's handles or couplers. 

| Coupler Size | Brass Part # | 316 Investment Stainless Steel Part # | Plated Iron Part # |
|--------------|----------------|---------------------------------------|--------------------|
| ¾" - 1" | BHSC175 | RHSC175 | --- |
| 1¼" - 2½" | BHSC152 | RHSC152 | IHSC152 |
| 3" and 4" | BHSC34 | RHSC34 | IHSC34 |



IHSC152



IH6

| Coupler Size | Brass Part # | Plated Iron Part # |
|--------------|--------------|--------------------|
| 6" and 8" | BH6 | IH6 |

EZ Boss-Lock™ Cam & Groove Handles

Features:

- investment cast stainless steel cam arm and lever
- 316 stainless steel spring
- stainless steel pin, washer, plated carbon steel pull ring



| Coupler Size | Brass Part # |
|-----------------|----------------|
| 3/4" - 1" | RHEZ175 |
| 1 1/4" - 2 1/2" | RHEZ152 |
| 3" - 5" | RHEZ34 |
| 6" and 8" | RHEZ6 |

Under no circumstances should the EZ Boss-Lock™ cam arms be used on any fitting not specifically produced for their use. The aluminum, brass and iron are made from sand castings. To ensure proper functioning of the EZ Boss-Lock™ cam arm assemblies, we sort the castings to ensure there is sufficient length and orientation on the lugs on the main casting to engage the lever. We also buff or grind the rougher sand cast surface to ensure that the lever will move freely. *The EZ Boss-Lock™ cam arms cannot be retrofitted onto existing aluminum, brass or plated iron Boss-Lock™ already in service.*



Dixon® Coupling Paddle Handles



316 investment cast stainless steel



brass

Features:

- Dixon® paddle handles are only to be used with standard Dixon® parts (not global). Handles do not interchange with other manufacturer's handles or couplers.
- not supplied with pins



| Coupler Size | Brass Part # | 316 Investment Cast Stainless Steel Part # |
|--------------|-------------------|--|
| 3" and 4" | 300H-PADBR | 300H-PADSS |

Cam & Groove Gasket Dimensions

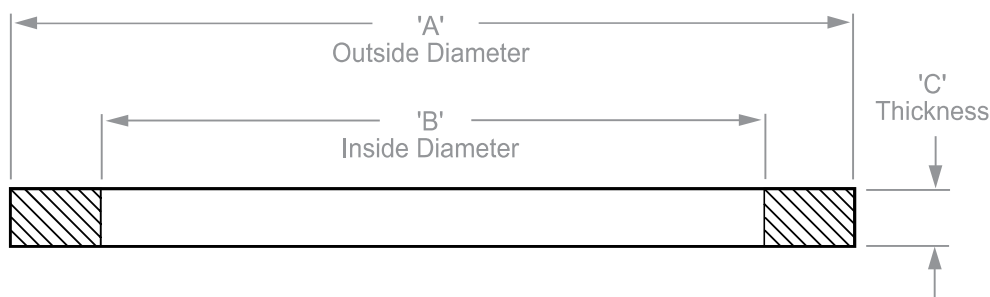

Cam & Groove

- nominal dimensions for elastomeric cam & groove gaskets are listed
- ID's of the PTFE envelope gaskets and the PTFE accordion gaskets are $1/16"$ smaller than the ID's for the elastomeric gaskets shown below
- thickness of PTFE accordion gaskets may vary from chart below

| Size | Part # | Dimensions | | |
|------------------|---------------------------|------------|----------|-------|
| | | A | B | C |
| $\frac{1}{2}"$ | 50-G ¹ | 1-1/32" | 11/16" | .156" |
| $\frac{3}{4}"$ | 75-G | 1-3/8" | 7/8" | .218" |
| 1" | 100-G | 1-9/16" | 1-1/16" | .250" |
| 1 $\frac{1}{4}"$ | 125-G | 1-15/16" | 1-23/64" | .250" |
| 1 $\frac{1}{2}"$ | 150-G | 2-3/16" | 1-5/8" | .250" |
| 2" | 200-G | 2-5/8" | 2" | .250" |
| 2 $\frac{1}{2}"$ | 250-G | 3-1/8" | 2-3/8" | .250" |
| 3" | 300-G | 3-23/32" | 3" | .250" |
| 4" | 400-G | 4-7/8" | 4" | .250" |
| 5" | 500-G | 5-15/16" | 4-7/8" | .250" |
| 6" | 600-G | 7-1/16" | 6" | .250" |
| 8" | 800-G ¹ | 9-5/16" | 8-1/8" | .343" |

¹ No interchange standard exists for the $\frac{1}{2}"$ and 8" fittings. Generally, these sizes do not interchange with other manufacturer's products. As such, the gaskets in these sizes are not suitable for use in other manufacturers' couplings.



Cam & Groove Gasket Color Codes

| Gasket Code ¹ | Material | Color | Color code stripes (appear on the OD of the gasket or filler) |
|--------------------------|--|---------------------|--|
| -BU | Buna-N (standard in all metal fittings) | black | 1 blue |
| -BF | Buna (formulated for fuel service) | black | 1 green |
| -VI | FKM | black | 1 yellow |
| -THK | Extra Thick Buna | black | 2 blue |
| -EPR | Ethylene Propylene | black | 1 white |
| -NE | Neoprene | black | 1 red |
| -WNE | White Neoprene, FDA approved material | white | none |
| -WB | White Buna-N, FDA approved material | white | blue |
| -SIL | Silicone | red | none |
| -TF | PTFE (TFE) envelope with Buna-N filler | white / black | 1 blue |
| TFVI | PTFE (TFE) envelope with FKM filler | white / black | 1 yellow |
| TFWB | PTFE (TFE) envelope with White Buna-N filler, FDA approved materials | white / white | blue |
| TFEP | PTFE (TFE) envelope with Ethylene Propylene filler | white / black | 1 white stripe |
| -TES | PTFE (FEP) encapsulated Silicone core, FDA approved materials | translucent / red | none |
| -TEV | PTFE (FEP) encapsulated FKM core | translucent / black | none |
| TFACC | PTFE (TFE) accordion, FDA approved materials | white | none |

¹ part number suffix

Since other manufacturer's coding systems vary, this chart should not be used as a reference in identifying gaskets of unknown origin.



Cam & Groove Gaskets

Cam & Groove



Buna-N



FKM

| Size | Buna-N Part # | FKM Part # |
|--------|------------------|---------------|
| 1/2" | 50-G-BU | 50-G-VI |
| 3/4" | 75-G-BU | 75-G-VI |
| 1" | 100-G-BU | 100-G-VI |
| 1 1/4" | 125-G-BU | 125-G-VI |
| 1 1/2" | 150-G-BU | 150-G-VI |
| 2" | 200-G-BU | 200-G-VI |
| 2 1/2" | 250-G-BU | 250-G-VI |
| 3" | 300-G-BU | 300-G-VI |
| 4" | 400-G-BU | 400-G-VI |
| 5" | 500-G-BU | 500-G-VI |
| 6" | 600-G-BU | 600-G-VI |
| 8" | 800-G-BU | 800-G-VI |



extra thick Buna-N



ethylene propylene

| Size | extra thick Buna-N Part # | Ethylene Propylene Part # |
|--------|------------------------------|------------------------------|
| 3/4" | --- | 75-G-EPR |
| 1" | 100GTHK | 100-G-EPR |
| 1 1/4" | 125GTHK | 125-G-EPR |
| 1 1/2" | 150GTHK | 150-G-EPR |
| 2" | 200GTHK | 200-G-EPR |
| 2 1/2" | 250GTHK | 250-G-EPR |
| 3" | 300GTHK | 300-G-EPR |
| 4" | 400GTHK | 400-G-EPR |
| 6" | 600GTHK | --- |

NEW



neoprene



white neoprene

| Size | Neoprene Part # | white Neoprene ¹ Part # |
|--------|--------------------|---------------------------------------|
| 3/4" | 75-G-NE | --- |
| 1" | 100-G-NE | --- |
| 1 1/4" | 125-G-NE | --- |
| 1 1/2" | 150-G-NE | 150-G-WNE |
| 2" | 200-G-NE | 200-G-WNE |
| 2 1/2" | 250-G-NE | --- |
| 3" | 300-G-NE | 300-G-WNE |
| 4" | 400-G-NE | 400-G-WNE |
| 5" | --- | 500-G-WNE |
| 6" | --- | 600-G-WNE |

¹ white neoprene gaskets contain FDA approved materials

white Buna-N



silicone

| Size | white Buna-N ¹ Part # | Silicone Part # |
|--------|-------------------------------------|--------------------|
| 1 1/2" | --- | 150-G-SIL |
| 2" | --- | 200-G-SIL |
| 3" | 300-G-WB | 300-G-SIL |
| 4" | 400-G-WB | 400-G-SIL |

¹ white Buna-N gaskets contain FDA approved materials

Fuel Gaskets

| Size | Material | Part # |
|------|---------------------------|------------------|
| 1½" | <i>Buna</i> | 150-G-BF |
| 2" | <i>Buna</i> | 200-G-BF |
| 3" | <i>Buna</i> | 300-G-BF |
| 4" | <i>Buna</i> | 400-G-BF |
| 3" | <i>extra thick Buna-N</i> | 300GTHKBF |
| 4" | <i>extra thick Buna-N</i> | 400GTHKBF |



Cam & Groove

Cam & Groove Envelope Gaskets

Features:

- *PTFE white Buna* filler (TFWB) contains FDA approved materials
- maximum operating temperatures for specific chemicals may be lower, contact Dixon® for specific recommendations

| Size | <i>PTFE (TFE) with Buna-N filler</i> Part # | <i>PTFE (TFE) with FKM filler</i> Part # |
|------|--|---|
| ½" | 50-G-TF | 50-G-TF-VI |
| ¾" | 75-G-TF | 75-G-TF-VI |
| 1" | 100-G-TF | 100GTFVI |
| 1¼" | 125-G-TF | 125GTFVI |
| 1½" | 150-G-TF | 150GTFVI |
| 2" | 200-G-TF | 200GTFVI |
| 2½" | 250-G-TF | 250GTFVI |
| 3" | 300-G-TF | 300GTFVI |
| 4" | 400-G-TF | 400GTFVI |
| 6" | 600-G-TF | 600GTFVI |

| Size | <i>PTFE (TFE) with white Buna-N filler</i> Part # | <i>PTFE (TFE) with Ethylene Propylene filler</i> Part # |
|------|--|--|
| 1½" | --- | 150GTFEP |
| 2" | 200GTFWB | 200GTFEP |
| 3" | 300GTFWB | 300GTFEP |
| 4" | 400GTFWB | --- |
| 5" | 500GTFWB | --- |

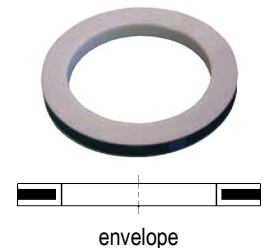

The torque (force) required to close the handles on a pair of cam and groove fittings will vary according to the gasket chosen. Due to the nature of the PTFE material, the various PTFE gasket designs will require the most torque, increasing as you go from envelope to encapsulated, and finally, accordion.

Cam & Groove Encapsulated Gaskets

Features:

- *PTFE encapsulated silicone* (TES) gaskets contain FDA approved materials
- encapsulated gasket pressure ratings are reduced to **125 PSI** for ¾" - 4" at ambient temperature **70°F (21°C)**
- *PTFE encapsulated FKM* (TEV) gaskets - maximum operating temperature **200°F (93°C)**
- *PTFE encapsulated silicone* (TES) gaskets - maximum operating temperature **225°F (107°C)**
- maximum operating temperatures for specific chemicals may be lower, contact Dixon® for specific recommendations



| Size | <i>PTFE (FEP) encapsulated silicone</i> Part # | <i>PTFE (FEP) encapsulated FKM</i> Part # |
|------|---|--|
| ¾" | 75-G-TES | 75-G-TEV |
| 1" | 100-G-TES | 100-G-TEV |
| 1¼" | 125-G-TES | 125-G-TEV |
| 1½" | 150-G-TES | 150-G-TEV |
| 2" | 200-G-TES | 200-G-TEV |
| 2½" | 250-G-TES | 250-G-TEV |
| 3" | 300-G-TES | 300-G-TEV |
| 4" | 400-G-TES | 400-G-TEV |

Cam & Groove Accordion Gaskets

Features:

- *PTFE* accordion gaskets (TFACC) are recommended for use with viscous (thick) fluids only
- maximum operating temperatures for specific chemicals may be lower, contact Dixon® for specific recommendations

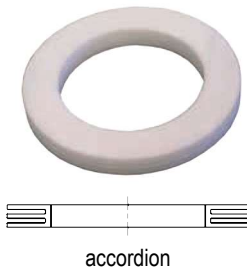

| Size | <i>PTFE (TFE)</i> Part # |
|------|-----------------------------|
| ¾" | 75GTFACC |
| 1" | 100GTFACC |
| 1¼" | 125GTFACC |
| 1½" | 150GTFACC |
| 2" | 200GTFACC |
| 3" | 300GTFACC |

The torque (force) required to close the handles on a pair of cam & groove fittings will vary according to the gasket chosen. Due to the nature of the PTFE material, the various PTFE gasket designs will require the most torque, increasing as you go from envelope to encapsulated, and finally, accordion.

Witches Hat Strainers

Features:

- used with female cam and groove couplings
- pre-attached Buna-N gasket

| Size | 304 Stainless Steel Part # |
|------|-------------------------------|
| 3" | WH300-A |
| 4" | WH400-A |



Cam & Groove

Gaskets for Witches Hat Strainers

| Size | Buna-N Gasket Part # |
|------|-------------------------|
| 3" | WH300-G |
| 4" | WH400-G |



Disk Strainers

Feature:

- threads into bottom of female NPT fitting to protect equipment from large contaminants

| Size | Hole Size | 6061T6 Aluminum Part # | 304 Investment Cast Stainless Steel Part # |
|------|-----------|---------------------------|--|
| 2" | 1/4" | SDA200 | SDS200 |
| 3" | 1/4" | SDA300 | SDS300 |
| 4" | 1/4" | SDA400 | SDS400 |



Pull Ring Safety Clips for Boss-Lock™

| Coupler Size | Carbon Steel Part # | 316 Stainless Steel Part # |
|-----------------|------------------------|-------------------------------|
| 3/4" - 1" | --- | 100PRSCSS |
| 1 1/4" - 2 1/2" | 200PRSCCS | 200PRSCSS |
| 3" and 4" | 300PRSCCS | 300PRSCSS |



Pull Rings

| 304 Stainless Steel Part # |
|-------------------------------|
| R200SS |



Sash Chain with Pull Rings

Feature:

- brass chain, plated steel pull ring

| Length | Part # |
|---------|-------------|
| 4 1/2" | J125 |
| 6 1/2" | J150 |
| 8 1/2" | J300 |
| 12 3/4" | J500 |





400-A-INSERT



400-C-INSERTAL

Abrasion Resistant Inserts

Features:

- extends the life of adapters when transferring proppant to storage tanks
- available for multiple adapter and multiple coupler materials

| Description | UHMW Polyethylene Part # |
|---|-----------------------------|
| to be used with 400-A-AL , 400-A-BR , 400-A-MI , 400-A-SS | 400-A-INSERT |
| to be used with 400-C-AL | 400-C-INSERTAL |
| to be used with 400-C-MI | 400-C-INSERTMI |

Clip for Boss-Lock™ Couplings



Feature:

- .072 stainless steel wire

| |
|---------------------------|
| Stainless Steel Part # |
| AC7 |

Clip Assembly



Features:

- for use with Boss-Lock™ couplings
- includes pull ring, chain and AC3 clip

| |
|-----------------------|
| CarbonSteel Part # |
| BLCA152CS |

Jack Chain with S-Hook



| Length | Material | Part # | Optional Qty |
|--------|--------------|-----------------|--------------|
| 6" | brass | CH-B-6 | 10 |
| 12" | brass | CH-B-12 | 10 |
| 24" | brass | CH-B-24 | --- |
| 12" | carbon steel | CH-C-12 | 10 |
| 6" | stainless | CH-SS-6 | 10 |
| 12" | stainless | CH-SS-12 | 10 |
| 24" | stainless | CH-SS-24 | 10 |

Locking Cam Arm Velcro® Straps

Application:

- use with cam & groove couplers to prevent spills, secure from damage, and hold in place during transport



coupler sold separately

Features:

- used on the female end of a cam & groove coupler
- high visibility orange hook and loop with metal buckle provides strength, durability and long life
- temperature range: **-70°F to 200°F (-57°C to 93°C)**

| Length | Used On | Part # |
|--------|------------------------|--------------|
| 12" | fits up to 1½" coupler | CVS12 |
| 18" | fits up to 3" coupler | CVS18 |
| 24" | fits up to 5" coupler | CVS24 |
| 36" | fits up to 8" coupler | CVS36 |

Lanyards with Clip for Boss-Lock™ Couplings

Materials:

- clip: carbon steel
- lanyard: nylon

| Coupler Size | Part # |
|-----------------------|-------------|
| $\frac{3}{4}$ " - 1" | ACL4 |
| $1\frac{1}{4}$ " - 4" | ACL2 |
| 6" | ACL3 |



PVC Coated Lanyards

Material:

- PVC coated carbon steel with aluminum crimp sleeves

Feature:

- one end factory crimped, one end uncrimped for field installation

| Length | Part # |
|--------|--------------|
| 15" | CAL15 |
| 25" | CAL25 |



Lanyard for Boss-Lock™ Couplings

Feature:

- breaking strength: 160 lbs.

| Overall Length | 304 Stainless Part # |
|----------------|-------------------------|
| 7" | LR7 |

